



Ing. Michael Raab – Sales Director



## CCE Munich 2017

Visit us during the CCE 2017 exhibition in Munich/Germany Hall B6 Stand 226 and have look in to the future



**Strategic Allianz**  
Oppliger srl and LYNX Poland Sp. z o.o. ul.  
Signed a very important strategic agreement and Oppliger will distribute the Lynx Gluing Plotters in Italy and other European countries



## New Facility We moved

We moved to our new production facility.  
Four times bigger in order to follow the growing request from the global market

● ● ● Swiss Engineering  
**"Yes we can... We've done it"**

## A NEW CONCEPT AIOL

All in one laminating  
Making sheet to sheet Litho  
Laminating more efficient than inline solutions  
Prefeeder and Logistics

## NEWSLETTER JANUARY 2017

### CCE Munich 2017

21 - 23 marzo 2017

Messe München, Monaco, Germania

www.cce-international.com

Visitateci al

Padiglione B6

Stand 226

Visit us during the CCE 2017 from 21<sup>st</sup> to 23<sup>rd</sup> March 2017 exhibition in Munich/Germany in Hall B6 Stand 226 and have look in to the future.

We will show you our new concepts and solutions regarding sheet to sheet litho laminating, All In One Laminating solutions, logistics and prefeeders, such as pallet normalizing systems in order to feed automatic diecutters with laminated materials in a fully automatic way.



## Discuss with us Sintesy S<sup>3</sup> - The full optional Sheet to Sheet Litho Laminator – Market Leading

The fully automatic sheet to sheet laminating line Oppliger series Sintesy model 1616 S<sup>3</sup> is a modern high-tech machine, which differs from the other existing products on the market through its technical characteristics

## High Speed – Compact – Accuracy - Flexibility – Heavy Construction - Modular – Safety – Energy Saving

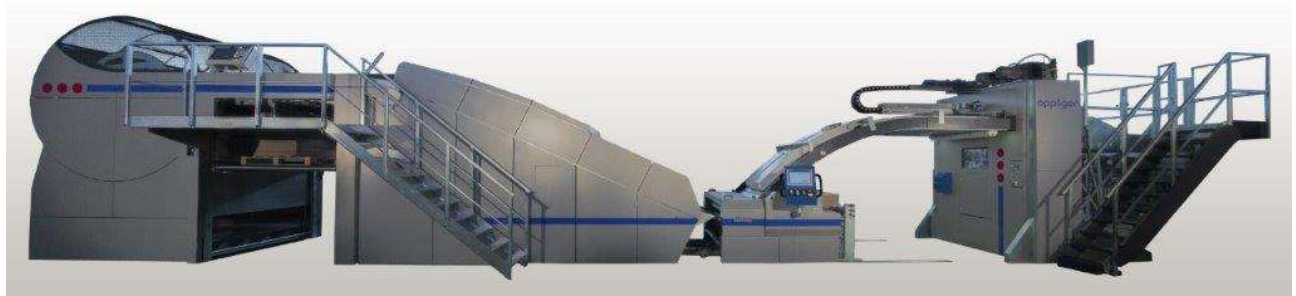

Sintesy 1616 S<sup>3</sup>

## High-Lights

- Edge to edge device
- Video control unit with cameras and monitor
- Router for teleservice
- “Two Steps Tool System”
- Innovative gluing unit to reduce glue consumption
- Led lights
- Special metallic colour version – Limited edition
- High speed and high precision solid board to solid board lamination
- Low weight cover sheets even 120g/m<sup>2</sup>

## Glue Saving Technology – no other machine makes it possible – Realistic example:

Glue saving technology – an important issue to pay the investment				
Glue saving g/m <sup>2</sup>	7,5			
Squaremeter production per year in m <sup>2</sup>	3.000.000,00	5.000.000,00	10.000.000,00	15.000.000,00
Costo of glue per kg in Euro	€ 0,70			
Glue saving per year in kg	22.500,00	37.500,00	75.000,00	112.500,00
Savings per year in Euro	€ 15.750,00	€ 26.250,00	€ 52.500,00	€ 78.750,00
No other machine is able to put less than 9 g/m <sup>2</sup> on the base sheet – even too few to laminate You can achieve the minimum level you need in order to save money and avoid the banana effect				



## Strategic Allianz

Oppliger srl and LYNX Poland Sp. z o.o. ul. signed a very important strategic agreement and Oppliger will distribute the Lynx Gluing Plotters in Italy and other European countries.

The Lynx gluing plotter mod. Felix is the most modern machine on market as it has the latest CNC technology on board.

### FELIX GLUER and FELIX GLUER COMBO

FELIX GLUER from LYNX Poland is a solution for precise dispensing of both hot melt and cold glues – an automatic CNC glue dispensing plotter. The machine is universal and versatile, dedicated to the packaging and POS manufacturing industries. What sets it apart from standard gluers is the ability to simultaneously apply glue to a few elements that differ in shape. Glue is applied with high speed and precision; the amount of glue is identical along the entire application length. The work area of the machine is divided into two independent moving work shelves. This facilitates the application of the adhesive to two elements that vary in thickness, at the same time. The plotter makes production faster by determining work cycles for the operator and eliminating time waste typical to manual application of glue.



*Felix Gluer*



*Felix Gluer Combo*

### Movies:

[https://www.youtube.com/watch?v=gCH\\_zQbdXPU](https://www.youtube.com/watch?v=gCH_zQbdXPU)

<https://drive.google.com/open?id=0Bzw2NiRUlxMebTFKc2RfZGZMMW8>

<https://drive.google.com/open?id=0Bzw2NiRUlxMeY3NxUjVaRHpHd28>

<https://drive.google.com/open?id=0Bzw2NiRUlxMeazNYZ001a0s0aE0>



## New Facility We settled over

We just moved to our new production facility. The new building is 4 times bigger than the previous one and allows out to follow the growing request from the global market.

Almost 2.500 m2 production and 600 m2 offices permit our company to increase activities, make delivery time shorter and offer a 360 degrees service to our customer base.



Soon our customer will be invited to the first open house event.

## New Address and contact information:

**Oppliger S.r.l.**  
**Via Mandolossa,55**  
**I-25030 Roncadelle**  
[info@oppliger.it](mailto:info@oppliger.it)  
tel. : +39 030 2774902  
fax.: +39 030 2525844  
[www.oppliger.eu](http://www.oppliger.eu)

All other contacts remain the same.

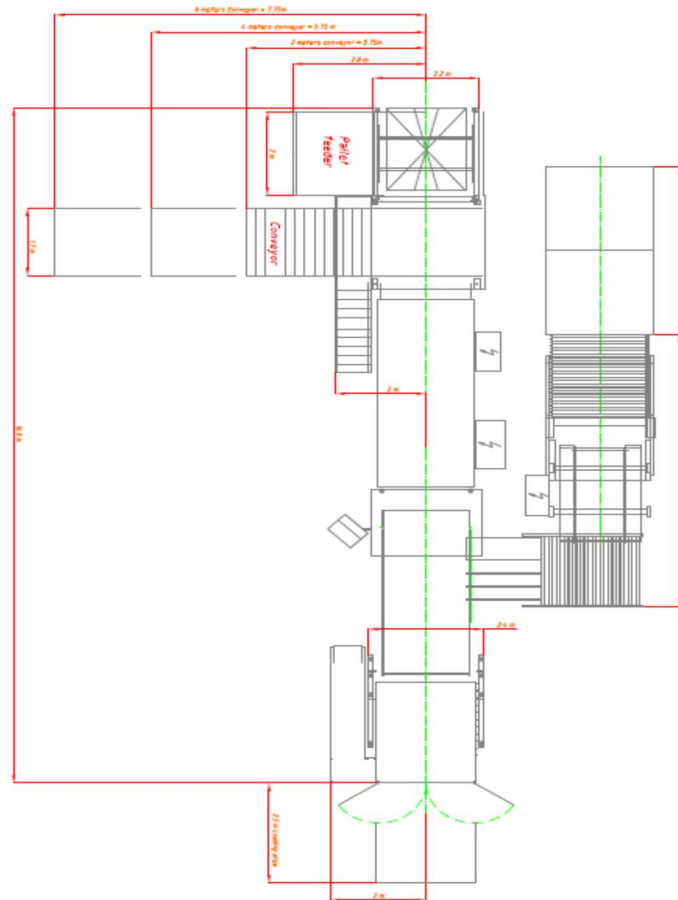
[illegible]

The new Oppliger concept combines your co

## 1. Fully Automatic Inline Process

**a. Corrugated Wet-End –Sheeter – Slitter –Stacker (Customer – external supplier)**

The Wet-End machine can be installed parallel or transversal to the Sintesy Laminator as the

**b. Intelligent Interface – Logistic – Prefeeder – Sintesy Laminator (Oppliger)**





After the stacker there is a logistic system with a buffer system for at least 6 piles, which transports the piles with the open flute to the suction belt feeder of the Sintesy Laminating Line, where a shingled stream of sheets loads the feeder constantly and without any interruption.

## 2. Fully Automatic Offline Process

### c. **Corrugated Wet-End –Sheeter – Slitter –Stacker (Customer – external supplier)**

The existing or to be installed corrugated Wet-End machine produces open flute, cuts it with the combined sheeter and side slitters to the desired format and builds the pile in the stacker on wooden pallets. These piles with sheets can be stocked for external customers and sale or for following internal productions.

### d. **Sintesy Laminator (Oppliger)**

While the corrugated Wet-End machine produces open flute for other or later uses the Sintesy laminating line will do other productions not suitable for an inline process, like covered flute, double flute or solid board as base materials.

This means that the user of the new AIOL (ALL IN ONE LAMINATING) concept will have the maximum flexibility of a sheet to sheet laminator and an inline solution:

**Sheet to sheet laminating with al suitable material**  
**Inline laminating with open flute**  
**Separate open flute production for other or later uses**



## Second hand machines

We can offer the following second hand machines which we have in stock:

**Ref. 142016 Grassi 142 – Fully Automatic Sheet to Sheet Litho Laminator with with Flip Flop device and Stacker**

Age 1994, fully maintained, very good conditions



**Ref. 152016 Grassi 125/1 – Folding Gluing machine with straight line, lock bottom and 4 corner device**

Age 1993, very good condition, CE certificated in 2002



**Other machines on request**